

DPX-IS 250 isolating switch by visible isolation, with or without release

Cat.No(s): 0 266 02/03/06/07/12/13/16/17/
 22/23/26/27/30/31/32/33/34/35/36/37/
 40/41/42/43/44/45/46/47/
 50/51/52/53/54/55/56/57

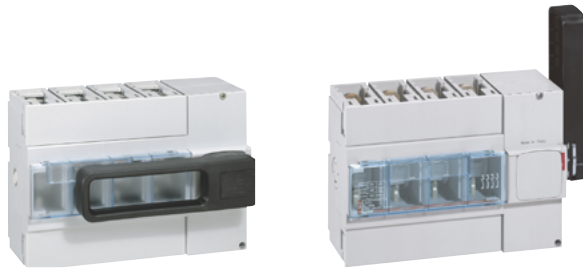

SOMMAIRE

Page

1. Use.....	1
2. Range	1
3. Dimensions.....	1
4. Connection.....	2
5. Technical characteristics	2
6. Marking	3
7. Equipments and accessories	3
8. Standards and regulations	4
9. Other informations	4

1. USE

DPX-IS allows safe disconnection of installations and electrical lines of 63 A to 250 A. They are available in 2 panel-mountable versions, with or without release, and come with terminal shields. Padlock integrated in the handle. DIN rail mounting possible in enclosure with adaptor Cat.No 0 262 39 or with mounting plate in vertical, horizontal or in transfer switch version (factory assembled).

2. RANGE

■ 2.1 With release

In (A)	Front handle		Right-hand side handle		Left-hand side handle	
	3P	4P	3P	4P	3P	4P
63	0 266 30	0 266 34	0 266 40	0 266 44	0 266 50	0 266 54
100	0 266 31	0 266 35	0 266 41	0 266 45	0 266 51	0 266 55
160	0 266 32	0 266 36	0 266 42	0 266 46	0 266 52	0 266 56
250	0 266 33	0 266 37	0 266 43	0 266 47	0 266 53	0 266 57

■ 2.2 Without release

In (A)	Front handle		Right-hand side handle		Left-hand side handle	
	3P	4P	3P	4P	3P	4P
160	0 266 02	0 266 06	0 266 12	0 266 16	0 266 22	0 266 26
250	0 266 03	0 266 07	0 266 13	0 266 17	0 266 23	0 266 27

RCD module: No
 Auxiliary contact or fault signal: Yes
 Shunt or undervoltage releases: Yes
 Motor-driven handle: No
 Rotary handle: Yes
 Fixed version: Yes
 Draw-out version: No
 Weight: 3 kgs

3. DIMENSIONS

■ 3.1 Installation

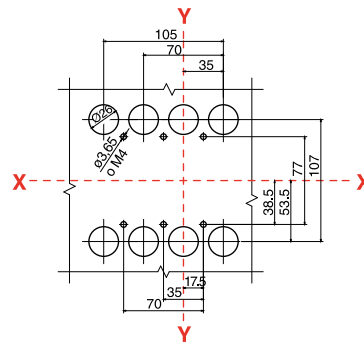

DIN rail mounting with adaptor Cat.No 0 262 39

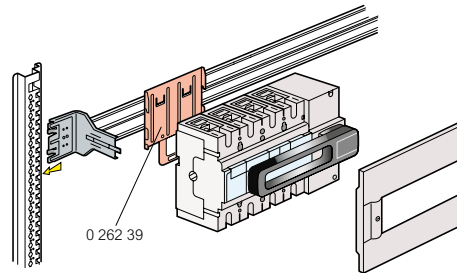

■ 3.2 Dimensions

Front handle

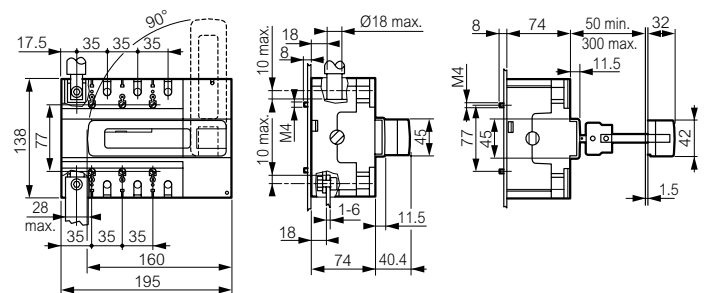

DPX-IS 250 isolating switch by visible isolation, with or without release

Cat.No(s): 0 266 02/03/06/07/12/13/16/17/
22/23/26/27/30/31/32/33/34/35/36/37/
40/41/42/43/44/45/46/47/
50/51/52/53/54/55/56/57

3. DIMENSIONS (continued)

3.2 Dimensions(continued)

Right-hand side handle

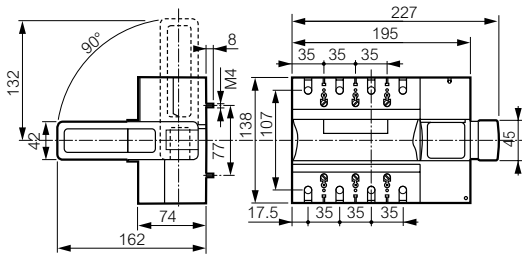

Left-hand side handle

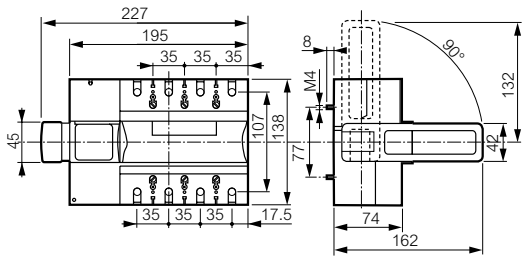

Front handle with terminal shields

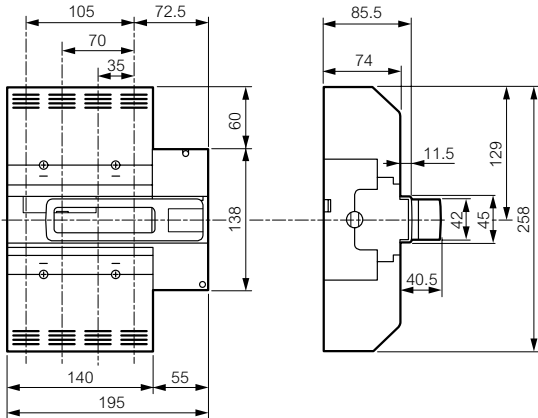

Mounted on rail

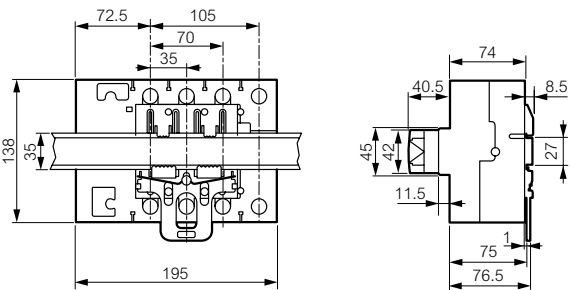

4. CONNECTION

4.1 DPX-IS front terminals

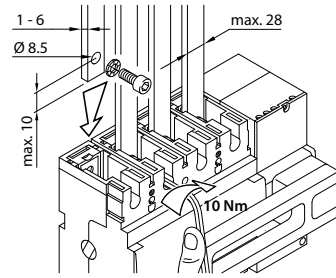

Connection by bars: connection range for copper and aluminium bars with a maximum width of 28 mm

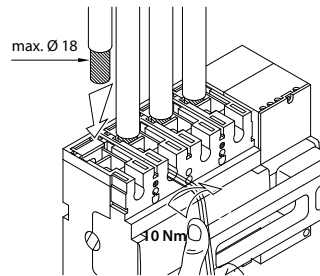

Connection by cables with terminals:
- for Cu/Al cables 185 mm² (rigid) or 150 mm² (flexible) : Cat.No 0 262 88

4.2 DPX-IS rear terminals

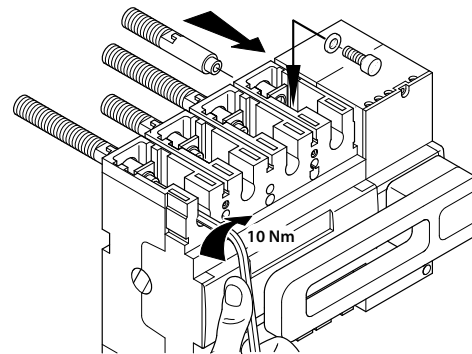

Set of rear terminals for top and bottom connections
3P : Cat.No 0 265 10 / 4P : Cat.No 0 265 11

5. TECHNICAL CHARACTERISTICS

5.1 Electrical and mechanical characteristics

	DPX-IS 250			
	63 A	100 A	160 A	250 A
Intensité nominale (In)	63 A	100 A	160 A	250 A
Rated operational current (Ie)	63 A	100 A	160 A	250 A
Rated frequency	50/60 Hz			
Short time withstand current (1 s) Icw	12 kA			
Current admissible with fuse Icc	100 kA			
Max. rating of fuse (gG - aM)	63 A	100 A	160 A	250 A
Rated insulation voltage (Ui):	800 V~			
Rated operational voltage (AC) Ue 50-60Hz	690 V~			
Rated impulse withstand voltage (Uimp)	8 kV~			
Short circuit making capacity (Icm peak)	15.3 kA			
Rated operating current (AC 22A) 690 V~	63 A	100 A	160 A	250 A
Rated operating current (AC 23A) 415 V~	63 A	100 A	160 A	250 A
Rated operating current (AC 23A) 690 V~	63 A	100 A	160 A	200 A
Rated operating current (DC 22A) 250 V= (2 poles in series):	63 A	100 A	160 A	250 A
Power dissipated per pole under In	0.5 W	1.3 W	3.3 W	8.1 W
Operating temperature range	- 25°C to + 70°C			
Electrical endurance (AC23 - 400 V~)	2500 operations			
Mechanical endurance (AC23 - 400 V~)	25000 operations			
Protection degree	IP 20			

Note: To calculate the total power dissipation, add the values for the installed accessories

5.2 Deratings

- Altitude

Altitude	2000 m	3000 m	4000 m
Ue	690 V	600 V	480 V
In (Ta = 40°C)	In	0.96 x In	0.93 x In

- Temperature

	Compensated rated current in accordance with ambient temperature (A)			
	40°C	50°C	60°C	70°C
DPX-IS 250	1	1	0.9	0.8

- Climatic conditions

According to IEC/EN 60947-1 Annex Q, Cat. F subject to temperature, humidity, vibration, shock and salt mist.

- Pollution degree

For DPX-IS isolating switch, degree 3, according to IEC/EN 60947-3

6. MARKING

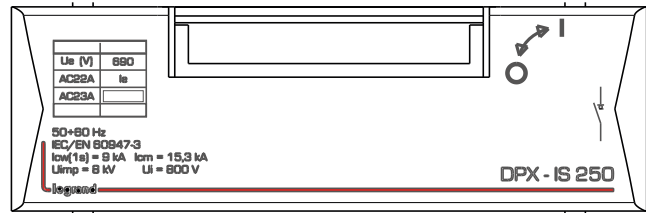

The marking includes: the laser label of the product on the front, the designation (type of product, code), compliance with standards, and the declared standard characteristics.

7. EQUIPMENTS AND ACCESSORIES

7.1 Releases

- shunt releases (inrush power = 300 VA) with voltage:

24 V~/= Cat.No 0 261 64

48 V~/= Cat.No 0 261 65

110 V~/= Cat.No 0 261 66

230 V~/= Cat.No 0 261 67

400 V~/= Cat.No 0 261 68

- undervoltage release (power consumption = 5 VA) with voltage:

24 V= Cat.No 0 261 70

24 V~ Cat.No 0 261 71

48 V= Cat.No 0 261 72

110 V~ Cat.No 0 261 76

230 V~ Cat.No 0 261 73

400 V~ Cat.No 0 261 74

- time-lag undervoltage releases (time-lag module + undervoltage release):

time-lag module 230 V~ Cat.No 0 261 90

time-lag module 400 V~ Cat.No 0 261 91

undervoltage release Cat.No 0 261 75

7.2 Auxiliary contacts

Changeover switch 3 A - 240 V~

Cat.No 0 261 60

For signalling the state of the contacts or opening of the protection device:

- OC: standard auxiliary contact

- CTR: fault signal

- CAO: opening anticipated contact

Rated voltage (Vn)	24 to 250 V AC/DC	
Rated current (In)	24 V DC	5 A
	48 V DC	1.7 A
	110 V DC	0.5 A
	230 V DC	0.25 A
	24/250 V AC	6 A

7. EQUIPMENTS AND ACCESSORIES (continued)

7.2 Auxiliary contacts (continued)

Possible settings:

- DPX-IS 250 without release: 1 auxiliary contact + 2 opening anticipated contacts
- DPX-IS 250 with release: 2 auxiliary contacts + 1 opening anticipated contact + 1 fault signal

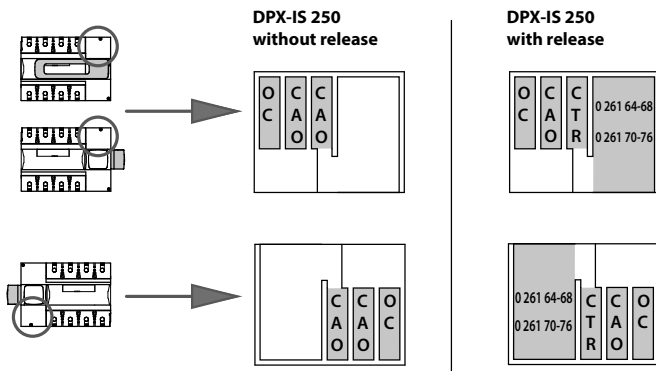

8. STANDARDS AND REGULATIONS

Compliant with IEC 60947-3 and EN 60947-3 standards
Compliant with UE, Morocco MA, ROHs and UKCA requirements

9. OTHER INFORMATIONS

Instruction use : all mounting informations available on e-catalogue

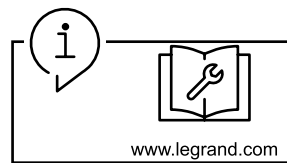

For further technical information, please contact Legrand technical support.
Unless otherwise indicated, data reported in this document refers exclusively to test conditions according to product standards.
For different conditions of use of the product, inside electrical equipment or in any different installation context, refer to the regulatory requirements of the equipment, local regulations and design specifications of the system.

7.3 Mechanical accessories

Cage terminals

Set of 4 terminals for Cu/Al cable
185 mm² (rigid) or 150 mm² (flexible) Cat.No 0 262 88

Rear terminals

Set of rear terminals for top and bottom connections
3P Cat.No 0 265 10
4P Cat.No 0 265 11

Spreaders

Incoming or outgoing spreaders Cat.No 0 262 48

Sealable terminal shields

Set of 2 terminal shields 3P Cat.No 0 262 87

Keylock

For locking mechanism in open position
Padlock with flat key Cat.No 0 266 92

7.4 Rotary handles

Direct for emergency use

Front and right-hand side handle Cat.No 0 266 89
Left-hand side handle Cat.No 0 266 90

Vari-depth handle IP 55

For front and side handle device Cat.No 0 266 86
For front and side handle device for emergency use
(to be ordered with Cat.Nos 0 266 89 or 0 266 90) Cat.No 0 266 87

7.5 Mounting accessory

Mounting on DIN rail accessory Cat.No 0 262 39