

**CP X-2 L2**

for **LA2**  
(osłony do LA2)

- (GB) Mounting instructions
- (DE) Montageanleitung
- (SI) Navodilo za montažo
- (PL) Instrukcje montażu
- (HR) Upute za montažu
- (CZ) Montážní návod
- (SK) Navod na montáž
- (HU) Szerelesési utmutató
- (LT) Montavimo instrukcija
- (RU) Инструкция за монтаж
- (LV) Montāžas instrukcija
- (EST) Paigaldusjuhend

CP 1-2 L2



CP 2-2 L2

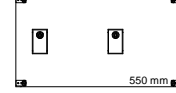

CP 1.4-2 L2

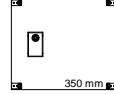

CP 3-2 L2

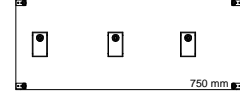

CP 2-2 L2

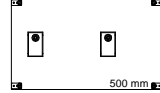

CP 3.8-2 L2

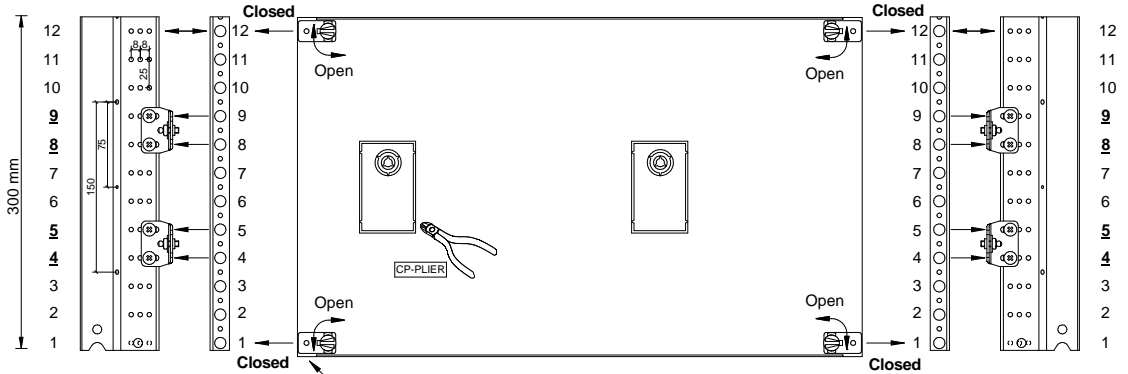
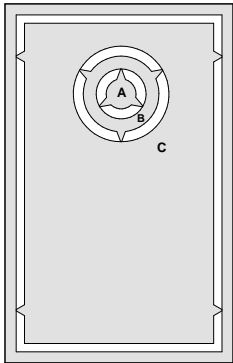
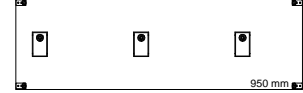

- Position 1** - with RO LA2 - cut out / remove **A, B**  
(z RO LA2 wyciąć / usunąć **A, B**)
- Position 2** - with ROD LA1,2 - cut out / remove **A, B, C**  
(z ROD LA1,2 wyciąć / usunąć **A, B, C**)
- Position 3** - with RO LA2 - cut out / remove **A, B, C**  
(z RO LA2 wyciąć / usunąć **A, B, C**)
- Position 4** - with ROD LA1,2 - cut out / remove **A**  
(z ROD LA1,2 wyciąć / usunąć **A**)

Position 1 and 2				
No.	Type ETI	Name	Pcs.	
1	LG-V5	Support	4	
2	AST 4.8x9.5	Tapping screw	8	
3	AW-RE 5	Washer M5 DIN9021 Zn	4	
4	AS-C 5x10	Screw M5x10 DIN7985 Zn	4	

Position 3				
No.	Type ETI	Name	Pcs.	
1	LG-V	Support	4	
2	AST 4.8x9.5	Tapping screw	8	
3	AW-RE 5	Washer M5 DIN9021 Zn	4	
4	AS-C 5x10	Screw M5x10 DIN7985 Zn	4	

Hole-position marker  
left-down  
(Otwór-znacznik pozycji  
lewy dolny róg)

Screwdriver flat-blade  
(Wkrętak płaski)

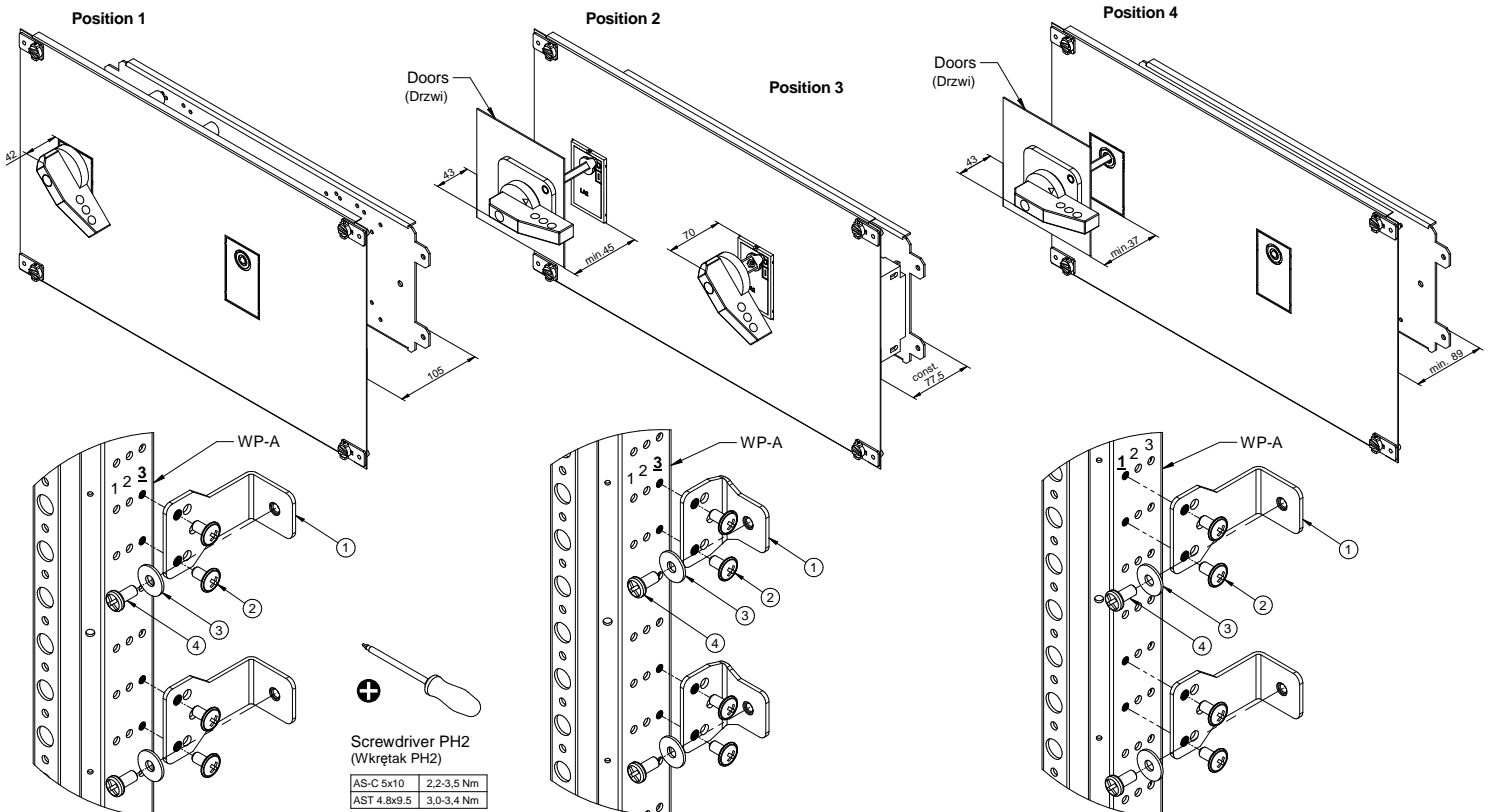

Screwdriver PH2  
(Wkrętak PH2)

AS-C 5x10	2,2-3,5 Nm
AST 4.8x9.5	3,0-3,4 Nm

CP X-2 L2

No.	Type ETI	Name	Pcs.
1	AS-C 4x20	Screw M4x20 DIN7985 Zn	4
2	AW-S 4	Washer spring M4 DIN127 Zn	8
3	AW-R 4	Washer M4 DIN126 Zn	4
4	AN-H 4	Nut M4 DIN934 Zn	4

Switch disconnectors montage in specified holes (black points)  
 (Rozłączniki montować w otworach oznaczonych czarnymi punktami)

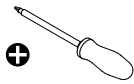
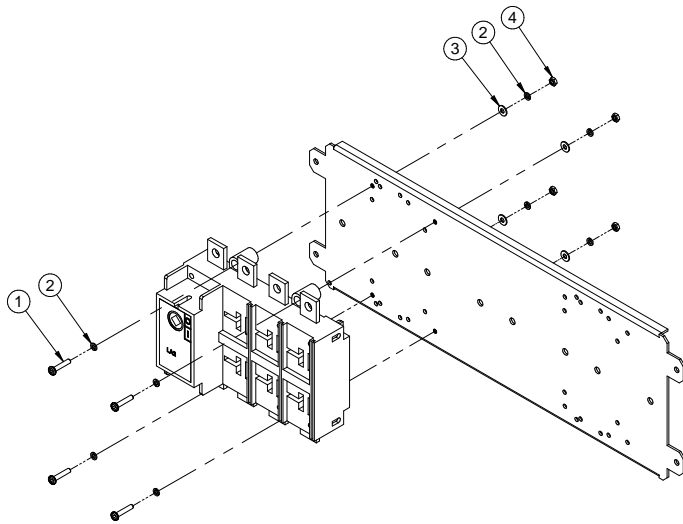

Screwdriver PH2  
 (Wkrętak PH2)  
 AS-C 4x20 | 1,7-2,2 Nm

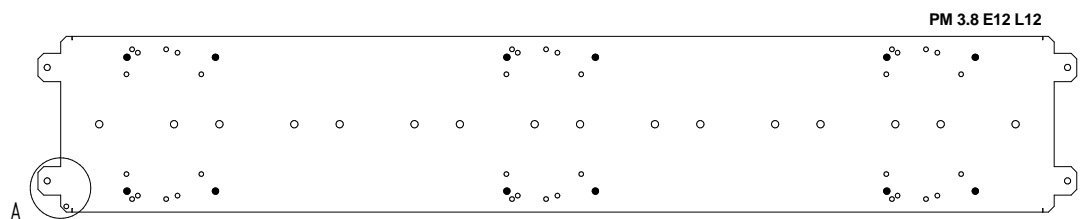
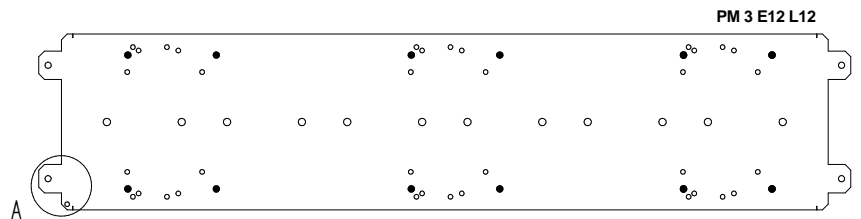
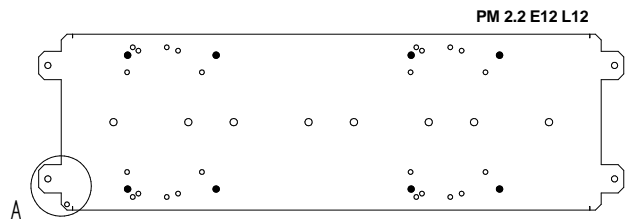
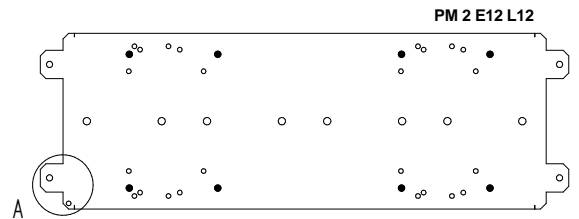
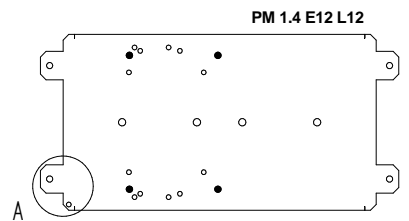
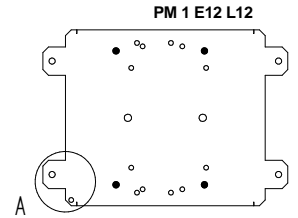

DETAIL A

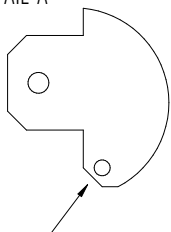

Hole-position marker  
**left-down**  
 (Otwór-znacznik pozycji  
 lewy dolny róg)