

**KFP 25 RL 18 (725 018)**



Figure without obligation

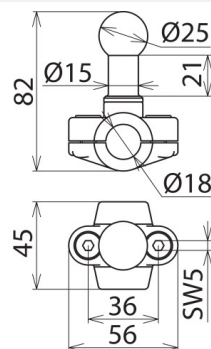

Figure without obligation

Type	KFP 25 RL 18
Part No.	725 018
Fixed ball point Ø	25 mm
For round conductor Ød	18 mm
Max. cable cross-section Cu	95 mm <sup>2</sup>
Max. short-circuit current I <sub>k</sub> 0.5 s	26.5 kA
Max. short-circuit current I <sub>k</sub> 1 s	18.7 kA
Standard	EN/IEC 61230 (DIN VDE 0683-100)
Material (fixed ball point)	E-Cu/gal Sn
Material (round conductor parts)	Copper alloy/gal Sn
Bolt	Hexagon socket-head bolt
Bolt material	Stainless steel
Weight	345 g
Customs tariff number (Comb. Nomenclature EU)	85359000
GTIN	4013364078048
PU	1 pc(s)

We reserve the right to introduce changes in performance, configuration and technology, dimensions, weights and materials in the course of technical progress. The figures are shown without obligation.