

**EL16 L5.05M 1KSO 8.10 1KSG 8 (416 450)**

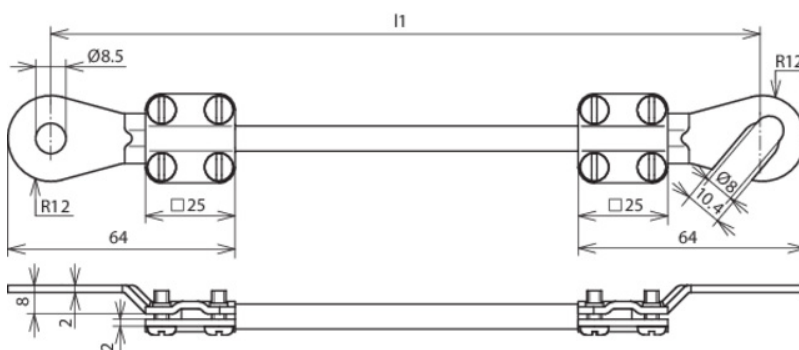

Figure without obligation



| Type  | EL16 L5.05M 1KSO 8.10 1KSG 8 |
|---|------------------------------|
| Part No.                                      | 416 450                      |
| Cable cross section                           | 16 mm <sup>2</sup>           |
| Cable length (l1)                             | 5.05 m                       |
| Cable lug open                                | M8 / M10                     |
| Cable lug closed                              | M8                           |
| Hole Ø  | 8.5 mm                       |
| Conductor                                     | Cu highly flexible           |
| Single wire diameter                          | 0.1 mm                       |
| Operating voltage resistance (AC / DC)        | 600 V                        |
| Temperature range                             | -40 °C ... +150 °C           |
| Colour  | black •                      |
| Cable lug material                            | Cu/gal Sn                    |
| Screw   | ⬆ M4 x 10 mm                 |
| Material of screw                             | St/gal Zn                    |
| Weight  | 1,04 kg                      |
| Customs tariff number (Comb. Nomenclature EU) | 85444290                     |
| Stock No.                                     | 6150-12-308-6929             |
| GTIN  | 4013364032521                |
| PU  | 1 pc(s)                      |

We reserve the right to introduce changes in performance, configuration and technology, dimensions, weights and materials in the course of technical progress. The figures are shown without obligation.

Packing in accordance with specifications of the VG standards (defence equipment standards) must be explicitly indicated when ordering.