

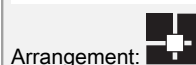

## AS S TE 20 7.10 FL40 V4A (620 915)

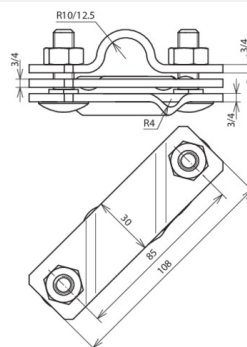

Figure without obligation



Arrangement:

Type	AS S TE 20 7.10 FL40 V4A
Part No.	620 915
Material	StSt (V4A)
Clamping range Rd / Fl	7-10 / -40 mm
Clamping range (stranded / cable)	35-95 mm <sup>2</sup>
Type for earth rods	Ø20 mm
Screw	⬆ M10 x 35 mm
Material of screw / nut	StSt (V4A)
Material No.	1.4571 / 1.4404 / 1.4401
Lightning current carrying capability (10/350 µs)	100 kA *)
Standard	EN 62561-1
Short-circuit current (a.c. 50 Hz / d.c.) (1 s; ≤ 300 °C)	7.3 kA
Weight	298 g
Customs tariff number (Comb. Nomenclature EU)	85359000
GTIN	4013364026629
PU	20 pc(s)

\*) For exact assignment, see test certificate.

We reserve the right to introduce changes in performance, configuration and technology, dimensions, weights and materials in the course of technical progress. The figures are shown without obligation.