

DMI 15 10 1 N (990 105)

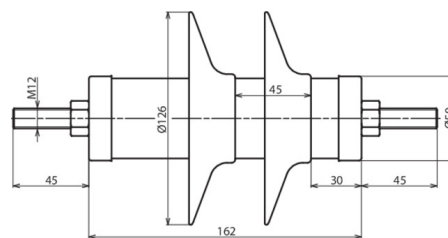

Figure without obligation



Dimension drawing DMI 15 10 1 N

| Type | DMI 15 10 1 N |
|---|---|
| Part No. | 990 105 |
| Nominal discharge current (8/20 μ s) (I_n) | 10 kA |
| High current impulse (4/10 μ s) | 100 kA |
| Overload capacity | 20 kA |
| Line discharge class (1) | 1 (2.8 kJ/kV U_r) |
| Long-duration current impulse (1) | 250 A / 2000 μ s |
| Rated voltage (a.c.) (U_r) | 15 kV |
| Continuous operating voltage (a.c.) (MCOV) (U_c) | 12.0 kV |
| Temporary overvoltage (TOV) at 1 sec. (U_{1s}) | 17.3 kV |
| Temporary overvoltage (TOV) at 10 sec. (U_{10s}) | 16.4 kV |
| Residual voltage at 10 kA (1/2 μ s) (\hat{u}_{res}) | 42.8 kV |
| Residual voltage at 5 kA (8/20 μ s) (\hat{u}_{res}) | 37.2 kV |
| Residual voltage at 10 kA (8/20 μ s) (\hat{u}_{res}) | 40.0 kV |
| Residual voltage at 20 kA (8/20 μ s) (\hat{u}_{res}) | 44.4 kV |
| Residual voltage at 40 kA (8/20 μ s) (\hat{u}_{res}) | 50.0 kV |
| Residual voltage at 125 A (40/100 μ s) (\hat{u}_{res}) | 29.2 kV |
| Residual voltage at 250 A (40/100 μ s) (\hat{u}_{res}) | 30.1 kV |
| Residual voltage at 500 A (40/100 μ s) (\hat{u}_{res}) | 31.2 kV |
| Residual voltage at 1000 A (40/100 μ s) (\hat{u}_{res}) | 32.4 kV |
| Residual voltage at 2000 A (40/100 μ s) (\hat{u}_{res}) | 34.0 kV |
| Insulation of arrester housing / nominal power frequency withstand voltage (dry) (U_{PFWL}) | 60 kV |
| Insulation of arrester housing / nominal power frequency withstand voltage (wet) (U_{PFWL}) | 40 kV |
| Insulation of arrester housing / nominal lightning withstand voltage (U_{LWL}) | 86 kV |
| Height (h) | 162 mm |
| Number of shields | 2 |
| Creepage distance (+/- 5%) | 288 mm |
| Torsional strength | 78 Nm |
| Maximum permissible dynamic service load (MPDSL) | 230 Nm |
| Tensile strength | 1400 N |
| Ambient temperature (T_a) | -40 °C ... +55 °C |
| Altitude | up to 1000 m above sea level |
| Power frequency (f_N) | 16-62 Hz |
| Housing material | HTV silicone housing |
| Colour | auburn, RAL 3013 |
| Fittings | terminals, screws and nuts of stainless steel |
| Conductor clamp | up to \varnothing 16 mm |
| Test standards | IEC 60099-4 |
| Weight | 1,3 kg |
| Customs tariff number (Comb. Nomenclature EU) | 85354000 |
| GTIN | 4013364102804 |
| PU | 1 pc(s) |

We reserve the right to introduce changes in performance, configuration and technology, dimensions, weights and materials in the course of technical progress. The figures are shown without obligation.