

**UEBS 16 L200 B10.5 B6.5 AL CU (377 210)**

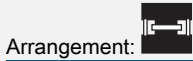

Figure without obligation

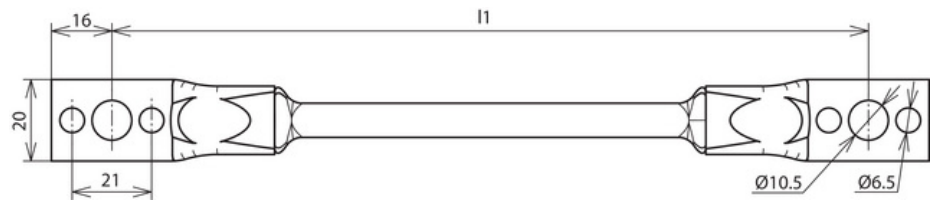

Type	UEBS 16 L200 B10.5 B6.5 AL CU
Part No.	377 210 ✓
Length (l1)	200 mm
Material of cable lug	Al
Material of cable	Cu
Cross-section	16 mm <sup>2</sup>
Fixing	[4x] Ø6.5 / [2x] Ø10.5 mm
Application note	Suitable for use outdoors. According to DIN EN 62305-3 Supplement 1, materials ≥ 0.5mm thick shall be connected by 2 rivets Ø6mm, or materials ≥ 2mm thick by 2 self-tapping screws Ø6.3mm StSt (on both sides)
Insulation	rubber EM5 black
Temperature range	-40 °C ... +80 °C
Cable type	flexible
Lightning current carrying capability (10/350 µs)	50 kA <sup>*)</sup>
Standard	EN 62561-1
Weight	53 g
Customs tariff number (Comb. Nomenclature EU)	85359000
GTIN	4013364083028
PU	10 pc(s)

<sup>\*)</sup> For exact assignment, see test certificate.

We reserve the right to introduce changes in performance, configuration and technology, dimensions, weights and materials in the course of technical progress. The figures are shown without obligation.