

EL16 L0.35M 2KSG 10 (416 903)

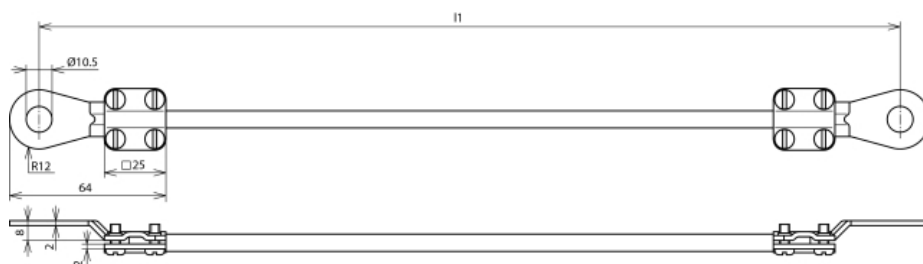

Figure without obligation

Type	EL16 L0.35M 2KSG 10
Part No.	416 903
Cable cross section	16 mm ²
Cable length (l1)	0.35 m
Cable lug closed	2x M10
Hole Ø	10.5 mm
Conductor	Cu highly flexible
Operating voltage resistance (AC / DC)	600 V
Temperature range	-40 °C ... +150 °C
Colour	black •
Cable lug material	Cu/gal Sn
Screw	⬆ M4 x 10 mm
Material of screw	St/gal Zn
Standard	EN 62561-1
Weight	132 g
Customs tariff number (Comb. Nomenclature EU)	85444290
Stock No.	6150-12-198-6812
GTIN	4013364028944
PU	1 pc(s)

We reserve the right to introduce changes in performance, configuration and technology, dimensions, weights and materials in the course of technical progress. The figures are shown without obligation.

Packing in accordance with specifications of the VG standards (defence equipment standards) must be explicitly indicated when ordering.