

**BES 17KG KT16 D337 (102 012)**

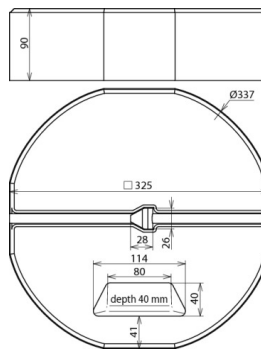

Figure without obligation

Concrete base without wedge for the erection of tripods and four-legged stands with M16 base support rods (e.g. part no. 107 390 + 107 396 ...).

Type	BES 17KG KT16 D337
Part No.	102 012
Component protection	German utility model No. 94 07 712.6
Type	stackable
Support	Ø16 mm
Diameter Ø	337 mm
Material	concrete (C45/55)
Weight	17,1 kg
Customs tariff number (Comb. Nomenclature EU)	68109100
GTIN	4013364105089
PU	54 pc(s)

We reserve the right to introduce changes in performance, configuration and technology, dimensions, weights and materials in the course of technical progress. The figures are shown without obligation.