

Product End of Life Instructions

VARIABLE SPEED DRIVE ATV630 IP21 90KW 400V/480V

Altivar Process ATV600/900 / Altivar Machine ATV340





Introduction and Scope

Legal Information	This product family is in the scope of European Union directive 2012/19/EU on Waste Electrical and Electronic Equipment (WEEE). This product may only be dismantled/disassembled and disposed of by appropriately trained persons and in compliance with all applicable regulations.	
Purpose	This document is intended for use by professional end of life recyclers or waste treatment facilities. It provides the basic information for proper end-of-life treatment of product components and materials.	
In case of special transportation: transportation method	No special transportation.	
Recyclability potential	81%	Based on "ECO'DEEE recyclability and recoverability calculation method" (version V1, 20 Sep. 2008 presented to the French Agency for Environment and Energy Management: ADEME).



Safety Information

The information provided in this document assumes that the product is completely de-energized and uninstalled (refer to the instructions provided in the appropriate product manuals).

Dismantling/disassembling the product may entail hazards caused by, for example, sharp edges, chemical aggression or ejected parts.

⚠ WARNING

HAZARD DUE TO INSUFFICIENT PROTECTION

- Implement all safety measures required by the applicable regulations and by the processes used to dismantle/disassemble and dispose of the product.
- Use all necessary personal protective equipment such as gloves and goggles.

Failure to follow these instructions can result in death or serious injury.



End of Life Instructions

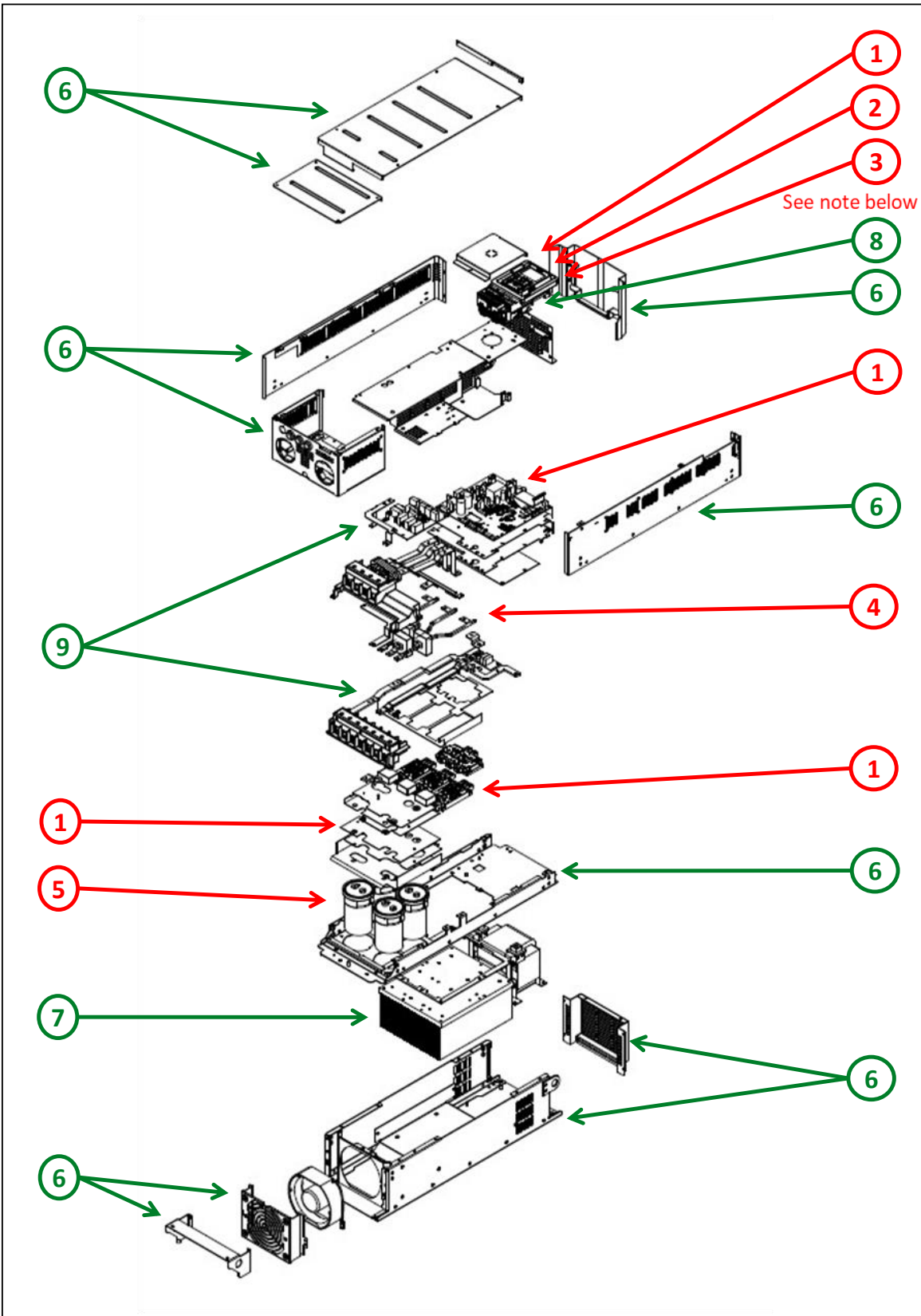

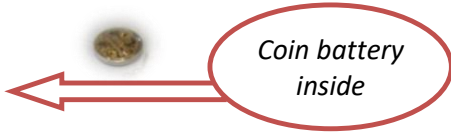

Recommendation	Number on drawing	Component / Material	Weight (in g)	Comment
To be depolluted	1	Electronic Board (Power and Communication) > 10cm ²	4369	
To be depolluted	2	LCD and all those back-lighted with gas discharge lamps	25	
To be depolluted	3	Other battery	2,9	Lithium content: 0,07 g
To be depolluted	4	Cable (high current)	1177	
To be depolluted	5	Electrolyte capacitors which size: height > 25 mm, diameter > 25 mm or proportionately similar volume	3200	
To be dismantled	6	Steel	25310	Upper and Lower Housing, Bar, Cover, Support, Chassis
To be dismantled	7	Aluminium	10916	Heatsink, Bar
To be dismantled	8	PC, ABS-PC, PA, PA6, HDPE, SAN with or without additives and other polymer	331	Control Housing, Control Chassis, Cover
To be dismantled	9	Copper	929	Bar
Other			12240,1	



Product description

Manufacturer identification	Schneider Electric Industries SAS
Brand name	Schneider Electric
Product reference	ATV630D90N4
Product function	The main function of the Altivar Process product range is the speed control and variation of a synchronous, asynchronous or reluctance electric motor for fluid management and industrial applications.
Description of the range	This range consists of products Altivar 630, Altivar 930 and Altivar 955 with ratings from 30 to 45 kW for operation on 200V/240V and ratings from 55 to 90 kW for operation on 400V/480V and of products Altivar 340 with ratings from 45 to 75 kW in heavy duty and 55 to 90 kW in normal duty cycle for operation on 400V/480V, 3-phase supplies IP21/UL type 1. For the Altivar 340 products, the normal duty mode constitutes the referential mode.
Total representative product mass	58,5 kg
Representative product dimensions	922mm x 290mm x 323mm
Accessories	No accessories needed.
Date of information release	11/2021

Schneider Electric Industries SAS

Country Customer Care Center
<http://www.schneider-electric.com/contact>

35 rue Joseph Monier
 CS 30323

FR 92500 Rueil Malmaison
 RCS Nanterre 954 503 439
 Capital social 896 313 776 €

www.schneider-electric.com

Published by Schneider Electric

ENVEOLI1411014_V3

© 2021 - Schneider Electric – All rights reserved

11/2021