

Product End of Life Instructions

VARIABLE SPEED DRIVE ATV630 IP21 160KW 400/480V

Altivar Process ATV600/900





Introduction and Scope

Legal Information	This product family is in the scope of European Union directive 2012/19/EU on Waste Electrical and Electronic Equipment (WEEE). This product may only be dismantled/disassembled and disposed of by appropriately trained persons and in compliance with all applicable regulations.	
Purpose	This document is intended for use by professional end of life recyclers or waste treatment facilities. It provides the basic information for proper end-of-life treatment of product components and materials.	
In case of special transportation: transportation method	No special transportation.	
Recyclability potential	80%	Based on "ECO'DEEE recyclability and recoverability calculation method" (version V1, 20 Sep. 2008 presented to the French Agency for Environment and Energy Management: ADEME).



Safety Information

The information provided in this document assumes that the product is completely de-energized and uninstalled (refer to the instructions provided in the appropriate product manuals).

Dismantling/disassembling the product may entail hazards caused by, for example, sharp edges, chemical aggression or ejected parts.

⚠ WARNING

HAZARD DUE TO INSUFFICIENT PROTECTION

- Implement all safety measures required by the applicable regulations and by the processes used to dismantle/disassemble and dispose of the product.
- Use all necessary personal protective equipment such as gloves and goggles.

Failure to follow these instructions can result in death or serious injury.

End of Life Instructions

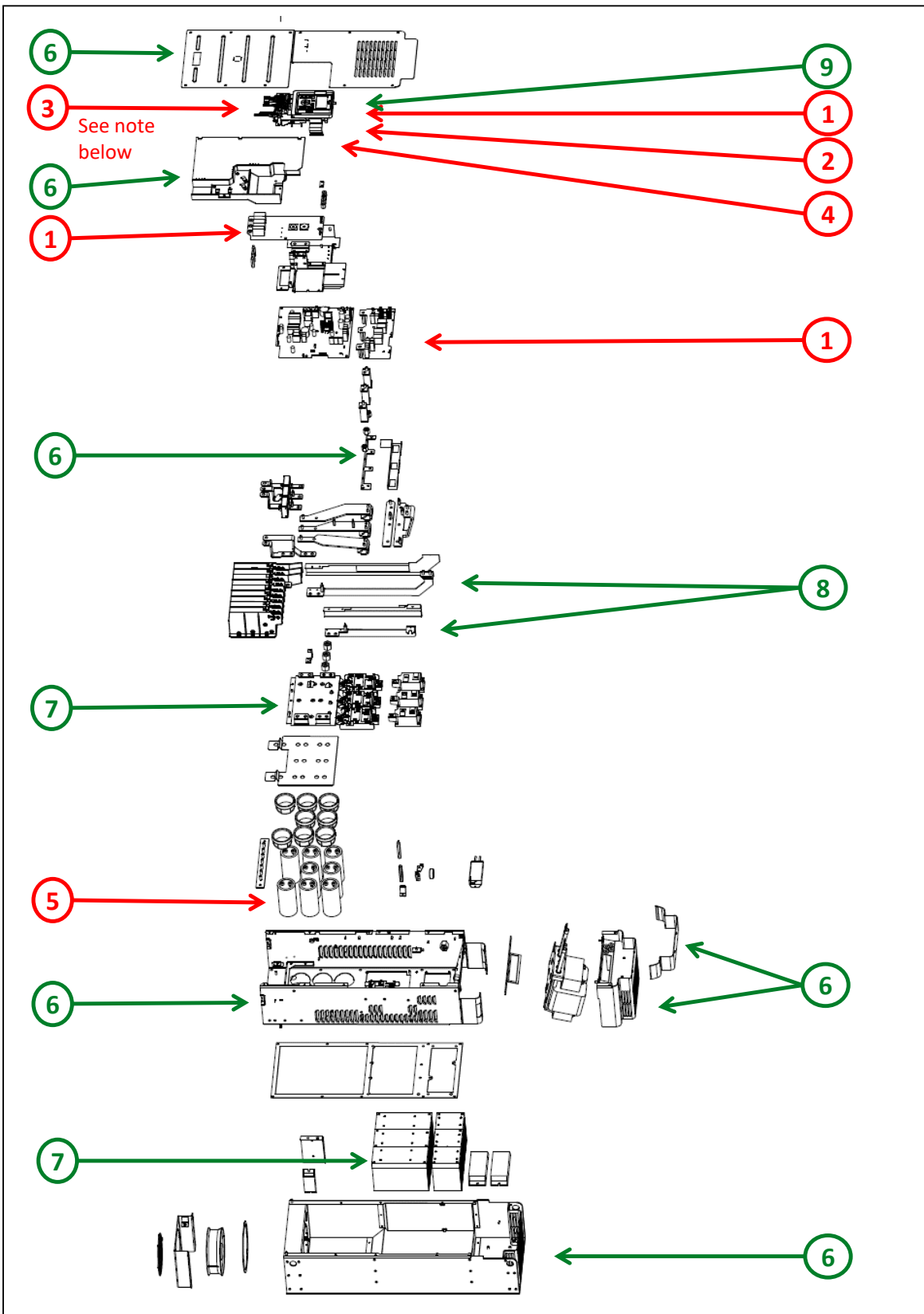

Note:



Recommendation	Number on drawing	Component / Material	Weight (in g)	Comment
To be depolluted	1	Electronic Board (Power and Communication) > 10cm ²	3657	
To be depolluted	2	LCD (surface > 100cm ²) and all those back-lighted with gas discharge lamps	6,7	
To be depolluted	3	Other battery	2,9	Lithium content: 0,07 g
To be depolluted	4	Cable (high current)	4181	
To be depolluted	5	Electrolyte capacitors which size: height > 25 mm, diameter > 25 mm or proportionately similar volume	4736	
To be dismantled	6	Steel	27645	Housing, Front cover, Bar
To be dismantled	7	Aluminium	16178	Heatsink, Bar
To be dismantled	8	Copper	4270	Bar
To be dismantled	9	PC, ABS-PC, PA, PA6, HDPE, SAN with or without additives	387	Housing
Other			25136	



Product description

Manufacturer identification	Schneider Electric Industries SAS
Brand name	Schneider Electric
Product function	The main function of the Altivar Process product range is the speed control and variation of a synchronous, asynchronous or reluctance electric motor for fluid management and industrial applications.
Product reference	ATV630C16N4
Total representative product mass	86200 g
Representative product dimensions	852 mm x 320 mm x 390 mm
Accessories	No accessories needed.
Date of information release	01/2021

Schneider Electric Industries SAS

Country Customer Care Center
<http://www.schneider-electric.com/contact>

35 rue Joseph Monier
 CS 30323
 FR 92500 Rueil Malmaison
 RCS Nanterre 954 503 439
 Capital social 896 313 776 €

www.schneider-electric.com

Published by Schneider Electric

ENVEOLI1501011_V3

© 2021 - Schneider Electric – All rights reserved

01/2021