

# Product End of Life Instructions

## Power Saving Personal Surge Protector

**Power Saving Personal Surge Protectors prevent electric surges from affecting computing and other electronic equipment.**





## Potential disassembly risks

No specific disassembly risks have been identified for this product



## End of Life Instructions

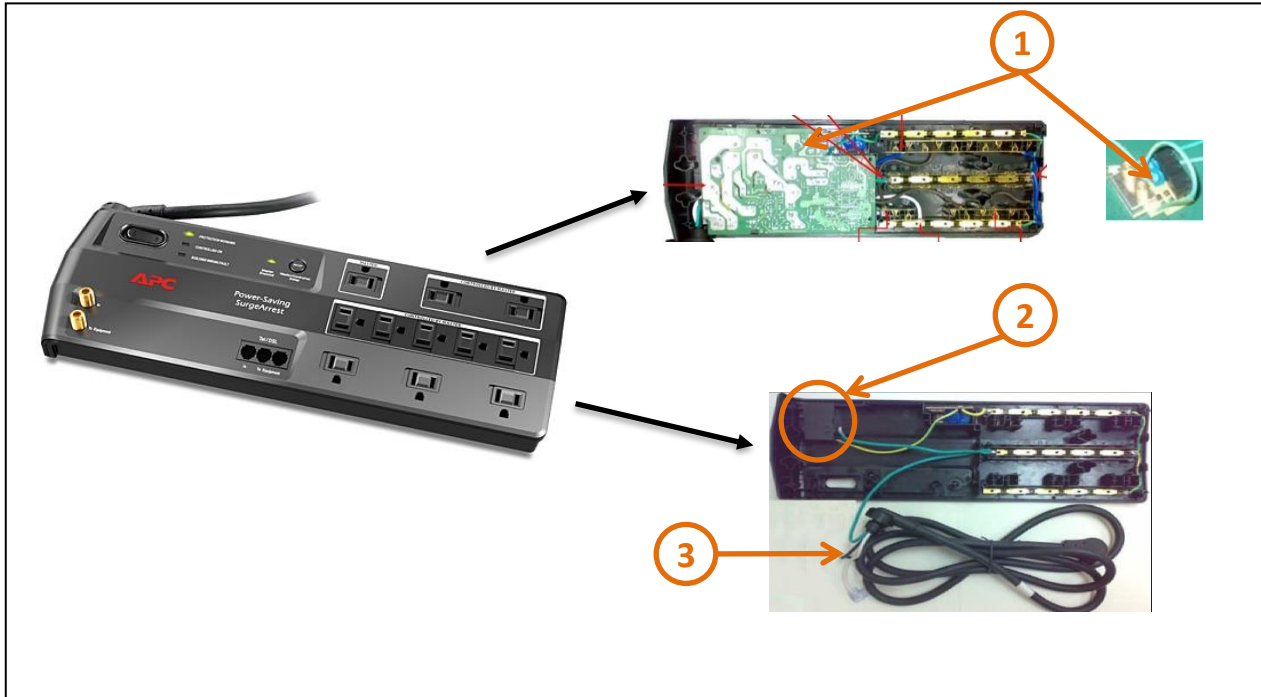

Recommendation	Number on drawing	Component / Material	Weight (in g)	Comment
To be depolluted	1	Electronic Board (Power) > 10cm <sup>2</sup>	225	2 x PCBAs
To be depolluted	2	Brominated-flame retardant ABS plastics	45	1 x Coaxial Cover
To be depolluted	3	External Electric Cables	200	1 x Power Cable



## Product description

Manufacturer identification	Schneider Electric Industries SAS
Brand name	APC
Product function	The P11GTV Power Saving Personal Surge Protectors provides automatic powersaving control over individual outlets, while distributing power and providing surge protection for multiple power outlets for individual computing and other electronic applications.
Product reference	P11GTV
Additional similar product references	PX(VNT)G(B)(C)(T)(V) where X is the number of outlets
Total representative product mass	1110 g
Representative product dimensions	40mm x 119mm x 363mm
Accessories	None
Date of information release	12/2018

## Additional information

<b>Legal information</b>	This product family is in the scope of European Union directive 2012/19/EU on Waste Electrical and Electronic Equipment (WEEE). The product family must be disposed according to the legislation of the country. This document is intended for use by end of life recyclers or treatment facilities. It provides the basic information to assure an appropriate end of life treatment for the components and materials of the product.	
<b>In case of special transportation: transportation method</b>	N/A	
<b>Recyclability potential</b>	<b>12%</b>	Based on "ECO'DEEE recyclability and recoverability calculation method" (version V1, 20 Sep. 2008 presented to the French Agency for Environment and Energy Management: ADEME).

Examples of other products in the product range:



Schneider Electric Industries SAS  
 Country Customer Care Center  
<http://www.schneider-electric.com/contact>  
 35, rue Joseph Monier  
 CS 30323  
 F- 92506 Rueil Malmaison Cedex  
 RCS Nanterre 954 503 439  
 Capital social 896 313 776 €  
[www.schneider-electric.com](http://www.schneider-electric.com)

Published by Schneider Electric  
 © 2018 - Schneider Electric – All rights reserved