

Product End of Life Instructions

M172 Performance Logic Controller

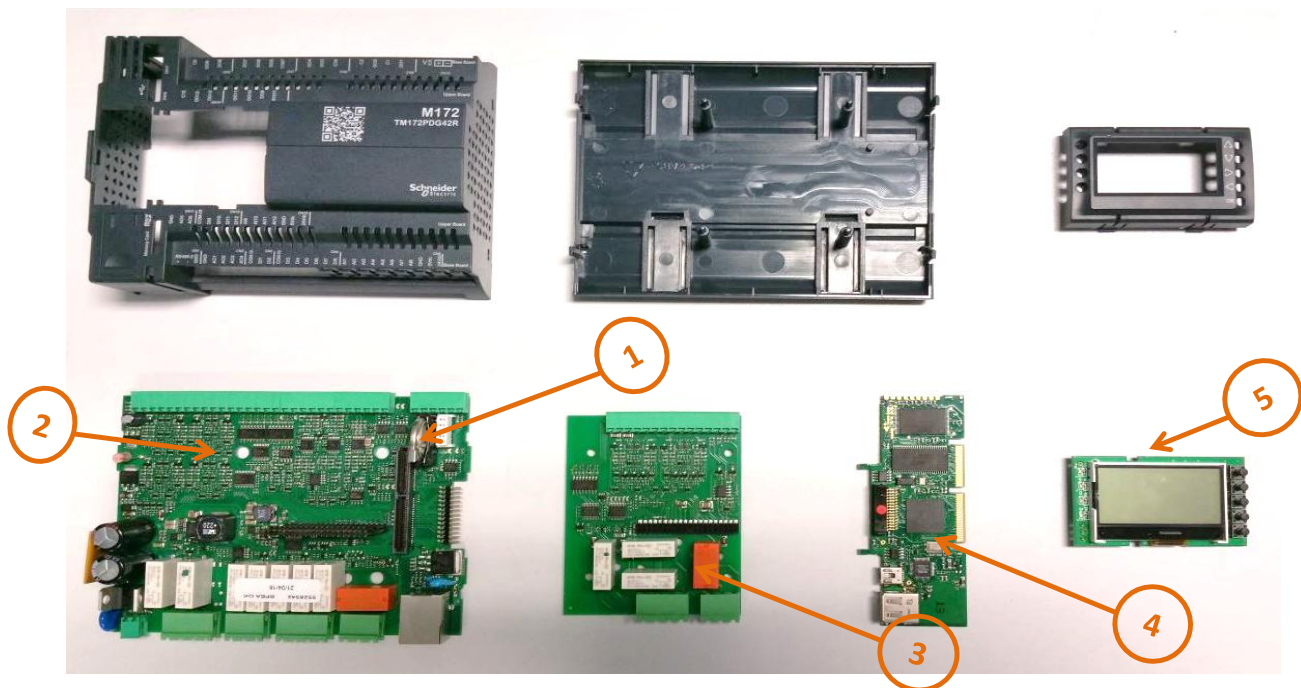

End of Life Instructions



Recommendation	Number on drawing	Component / Material	Weight (in g)	Comment
To be depolluted	1	Other battery	2,5	Lithium battery
To be depolluted	2	Electronic Board (Power) > 10cm ²	53	PCBA
To be depolluted	3	Electronic Board (Power) > 10cm ²	23	PCBA
To be depolluted	4	Electronic Board (Power) > 10cm ²	18	PCBA
To be depolluted	5	Electronic Board (Power) > 10cm ²	20	PCBA + Display

Product description

Manufacturer identification	Eliwell Controls srl
Brand name	Schneider Electric
Product function	The TM172PDG42S is a Schneider Electric programmable controller with a built-in graphical user display, part of the range Modicon M171/M172, suitable for managing a wide range of HVAC, pumping and many other applications, from the simplex to the most complex. The reference is available as 8 DIN rail-mounted version, which saves time in terms of wiring. The 8 DIN format provides extra flexibility and easy installation.
Product reference	TM172PDG42S
Additional similar product references	TM172PDG42S TM172PBG28R TM172PBG42R TM172PDG28R TM172PDG28S TM172PDG42R TM172E12R TM172E28R EPA00FCTA500 EPA00PCTA500 EPA01FCTA500 EPA01PCTA500 EPAS0FCTA500 EPAS0PCTA500 EPAS1FCTA500 EPAS1PCTA500 EVE1020000500 EVE6000000500 TM172ASCTB12E TM172ASCTB28E TM172ASCTB28
Total representative product mass	385 g
Representative product dimensions	110mm x 144mm x 60,5mm
Accessories	0

Additional information

Legal information	This product family is in the scope of European Union directive 2012/19/EU on Waste Electrical and Electronic Equipment (WEEE). The product family must be disposed according to the legislation of the country. This document is intended for use by end of life recyclers or treatment facilities. It provides the basic information to assure an appropriate end of life treatment for the components and materials of the product.	
In case of special transportation: transportation method	0	
Recyclability potential	11%	Based on "ECO'DEEE recyclability and recoverability calculation method" (version V1, 20 Sep. 2008 presented to the French Agency for Environment and Energy Management: ADEME).

Eliwell Controls srl
Eliwell Technical Support
Techsuppeliwell@schneider-electric.com
+39 0437 986300
15, Via dell'Industria
32016
Alpago - Belluno
0