

Mosaic™ TV/R passthrough and terminal sockets

Cat. Nos : 0 787 87/88

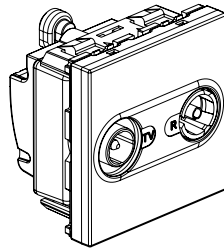

1. USE

Permet la réception des signaux TV et radio.

Câble recommandé 17/19 VATC

Blindage Classe A - Câblage en dérivation

Compatible UHD

2. RANGE

Cat. No.	Item	No. of modules
0 787 87	14 dB TV/R passthrough socket	2
0 787 88	10 dB TV/R terminal socket	2

3. DIMENSIONS (mm)

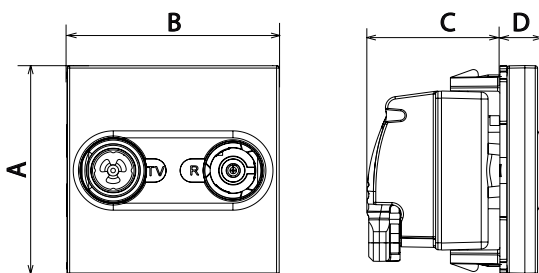

Cat. No.	A	B	C	D
0 787 87 - 0 787 88	45	45	28,1	8,5

4. CONNECTION

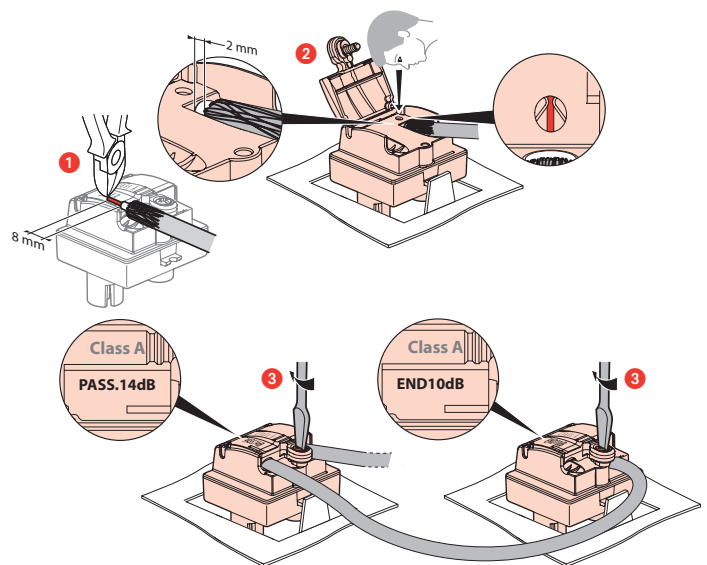

5. WIRING PRECAUTIONS

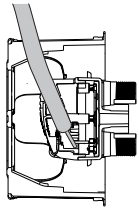
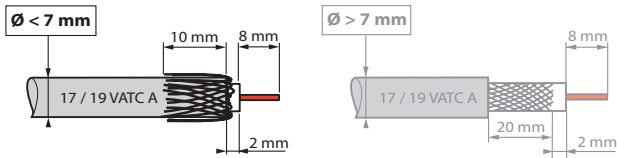

Connection from the rear of the socket reduces deformation of the coaxial cable, thus avoiding the risk of impedance loss and impaired performance.

6. TECHNICAL CHARACTERISTICS

6.1 Mechanical characteristics

Protection against solid bodies and liquids: IP 21
 Protection against impact: IK 04
 Cable strength 120 N: IEC 61169-24

6.2 Material characteristics

- Material:**
- Cover plate: ABS
 - Zero halogen
 - UV resistant
- Motor:**
- Casing: Zamac
 - Cover: Zamac
 - Pin: Bronze
 - Screws: Zinc-plated steel

6.3 Electrical characteristics

- Male connector \varnothing 9.52 mm (TV)
- Female connector (radio)
- Characteristic impedance: 75 ohm

Class A shielding efficiency (class A shielding is necessary to prevent interference from 3G and 4G phone signals, as these undesirable signals can cause pixellation of on-screen images or distort soundtracks)

- Frequency bands: TV: 5-68/120-862 MHz
 R: 87.5-108 MHz
- Insulation resistance: IEC 61169-24

6.4 Climate characteristics

Storage and operating temperature: -5 °C to +35 °C

7. CLEANING

Clean the surface with a cloth.
 Do not use acetone, tar-removing cleaning agents or trichloroethylene.
 Resistant to the following products: hexane (EN 60669-1), methylated spirit, soapy water, diluted ammonia, bleach diluted to 10%, window-cleaning products, pre-impregnated wipes.

Caution: Always test before using special cleaning products.

8. STANDARDS AND APPROVALS

- EN 50083-2
- Class A certificate

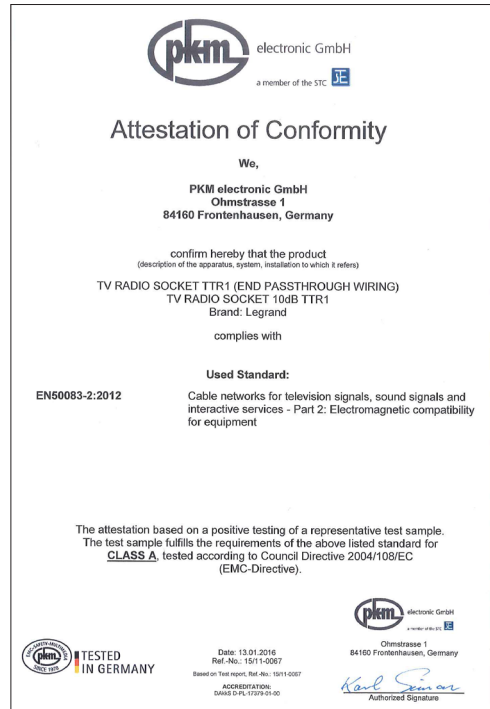
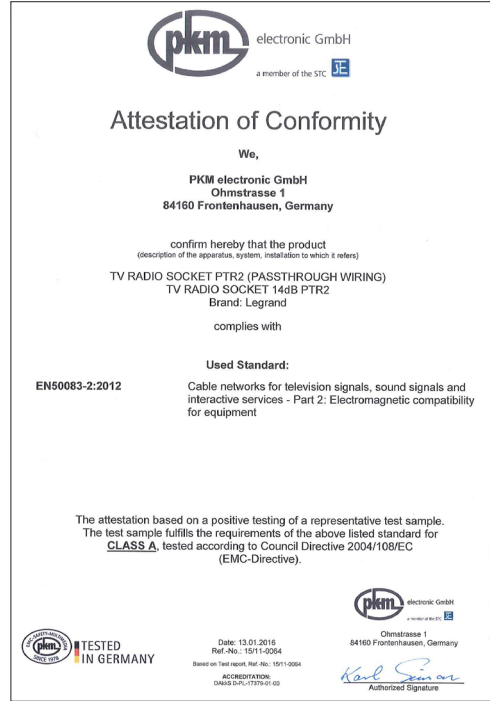

9. PERFORMANCE

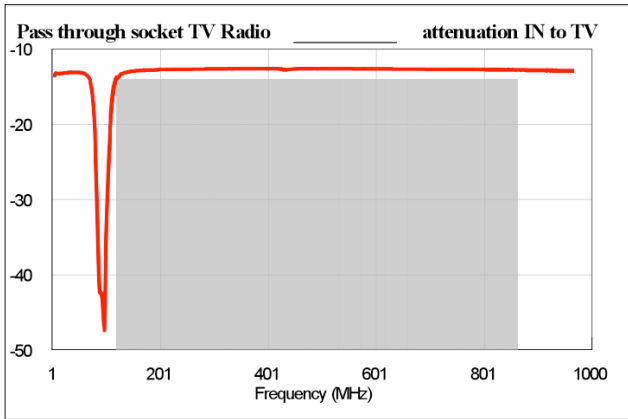

9. PERFORMANCE

