

Centralised vacuum cleaning outlets with electrical contact

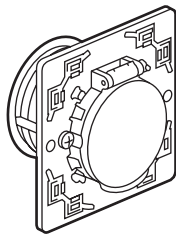

0 674 32/33

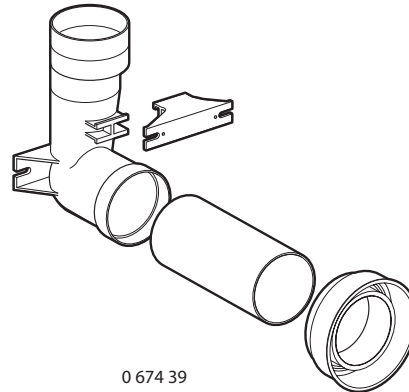

0 674 39

1. USE

Allows the connection of a vacuum cleaner hose in a centralised vacuum cleaning system.

Do not require mounting box.

Connects with tube Ø 51 mm and receives flexible Ø 38 mm.

Socket outlets delivered complete.

2. RANGE

Description	Cat. Nos	
Centralised vacuum cleaning outlet with electrical contact. Work with the following systems: Générale d'aspiration, Aldes, c.Dooble, Tréma, Turbix.	0 674 32 White	0 674 33 Titane
Connection kit for centralised vacuum cleaning outlet. Includes straight and L-shaped connection accessories.	0 674 39	

3. DIMENSIONS (mm)

Cat. Nos: 0 674 32/33

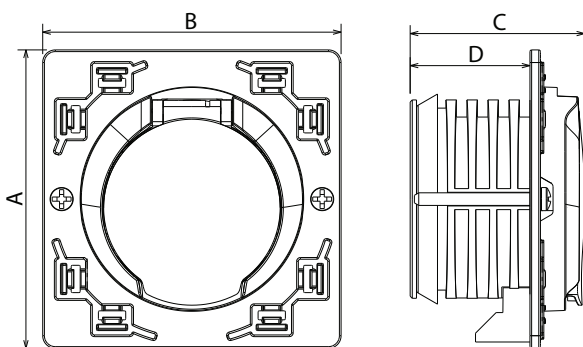

A	B	C	D
71	71	41.53	28.5

3. DIMENSIONS (mm) (continued)

Cat. Nos: 0 674 39

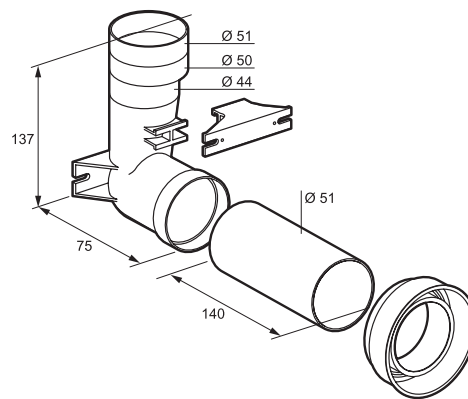

4. MOUNTING

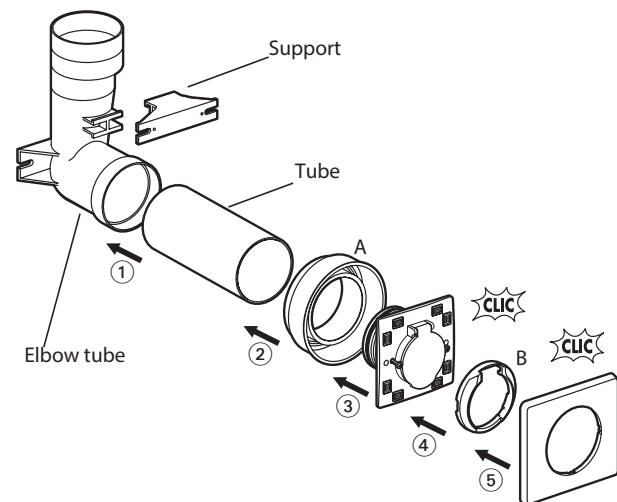

This installation outlet can be mounted on a peripheral wall, on a partition wall, or in a cupboard.

**Note:** To ensure product compatibility, pay attention to the diameter and length of the vacuum cleaner hose connector.

## Centralised vacuum cleaning outlets with electrical contact

### 4. MOUNTING *(continued)*

Diagram of typical vacuum cleaner hose connector on outlet side.

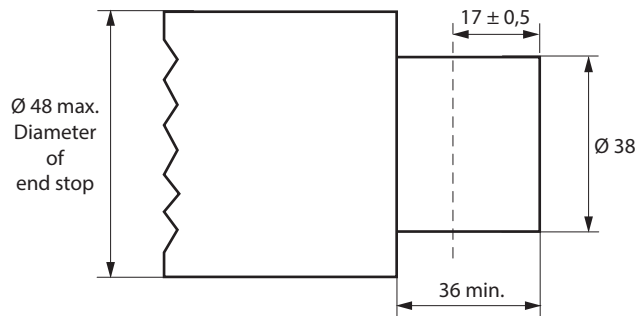

### 5. TECHNICAL CHARACTERISTICS

#### ■ 5.1 Mechanical characteristics

Protection against solid and bodies liquids: IP 20  
Protection against impact: IK 02

#### ■ 5.2 Material characteristics

Outlet: ABS  
Elbow tube, tube, support : PVC  
Self extinguishing: + 650° C / 30 s.

#### ■ 5.3 Electrical characteristics

Voltage: 12 V

#### ■ 5.4 Climatic characteristics

Storage temperature: - 10° C to + 70° C  
Use temperature: - 5° C to + 45° C

### 6. CLEANING

Surface cleaning with a cloth.

Do not use: acetone, tar remover, trichlorethylene.

**Caution:** A preliminary test should be carried out if other a specific cleanin products are to be used.

### 7. STANDARDS AND APPROVALS

Compliance with standards of installation and manufacturing.  
Refer to e. catalogue.