

**Céliane™**  
**Opening controls**

Cat. No(s): 0 676 01/02/03

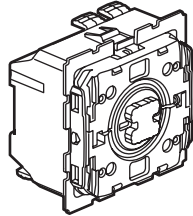

0 676 01

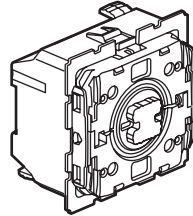

0 676 02

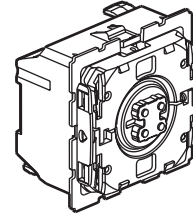

0 676 03

**1. USE**

Control mechanisms for roller shutters, blinds and awnings.

**2. RANGE**

Designation	Cat. No.
Switch for roller shutters / blinds / awnings	0 676 01
Pushbutton for roller shutters / blinds / awnings	0 676 02
Pushbutton direct control for roller shutters / blinds / awnings	0 676 03

**3. OVERALL DIMENSIONS (mm)**

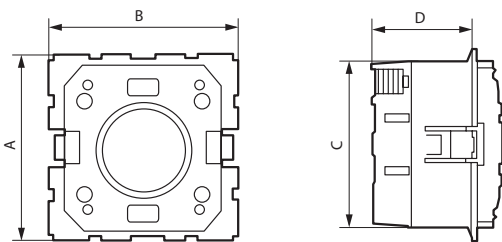

A	B	C	D
45	45	40.3	23.4

**4. CONNECTION**

Terminal type: automatic  
 Stripping: 13 mm  
 Terminal capacity: 2 x 2.5 mm<sup>2</sup>

■ 4.1 Pushbutton wiring (Cat. No. 0 676 02)

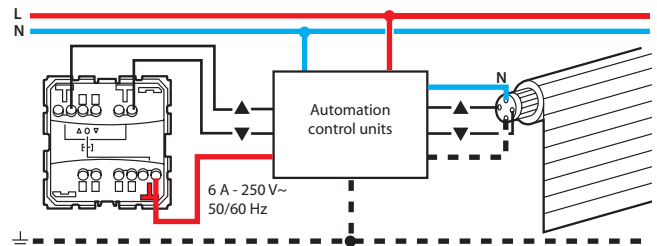

■ 4.2 Switch wiring (Cat. No. 0 676 01)

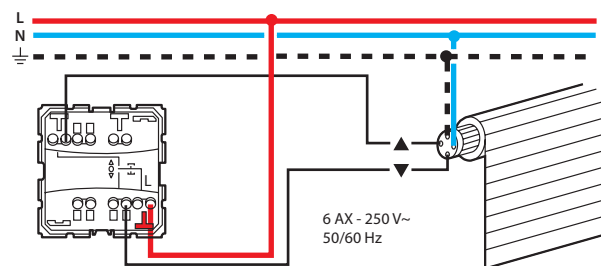

■ 4.3 Pushbutton wiring (Cat. No. 0 676 03)

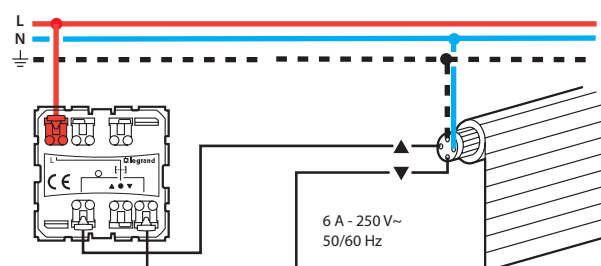

#### 4. CONNECTION (continued)

##### ■ 4.3 Pushbutton wiring (Cat. No. 0 676 03) with relay

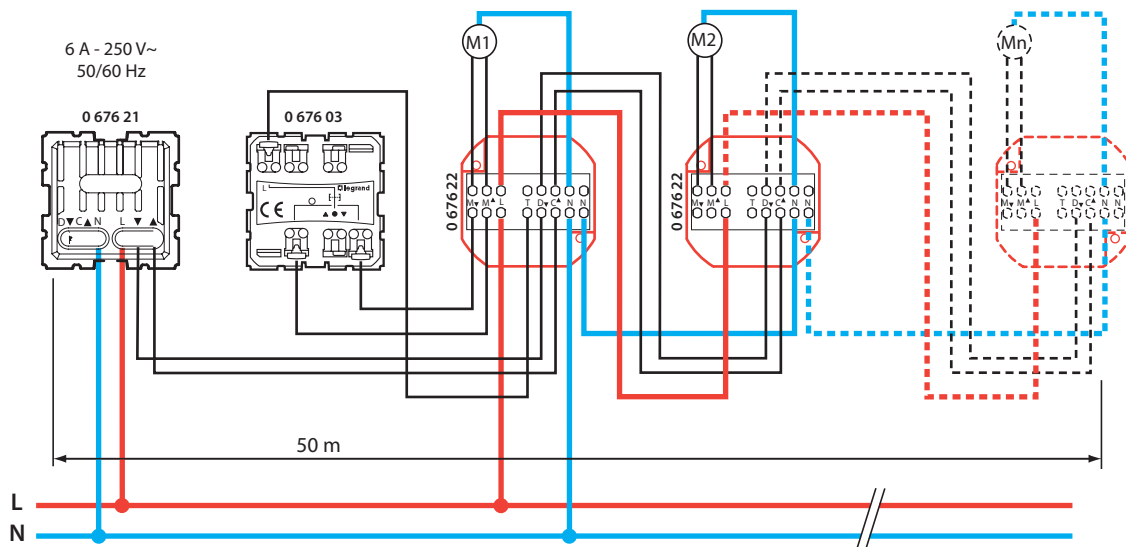

#### 5. OPERATION

Cat. No. 0 676 01: double switch for direct control of opening drives (fixed position mechanism).

Cat. No. 0 676 02: double pushbutton for controlling one or more opening drives via automation control units (closing mechanism).

Cat. No. 0 676 03 : double pushbutton for relay control (closing mechanism) of motor opening (without STOP).

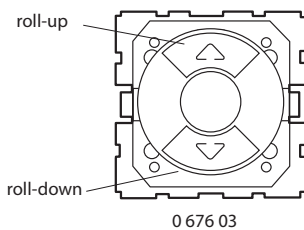
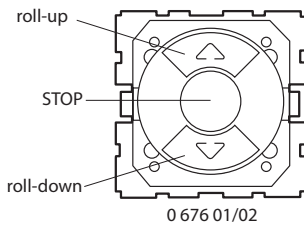

#### 6. TECHNICAL DATA

##### ■ 6.1 Technical characteristics

Impact tests: IK 04  
Penetration by solid/liquids bodies: IP 41 (C15-1000) } no rocker

##### ■ 6.2 Material characteristics

Housing: Polycarbonate

##### ■ 6.3 Electrical characteristics

Self-extinguishing: 650° C / 30 s

Voltage: 250 VAC

Current: 0 676 01 : 6 AX

0 676 02/03 : 6 A

Max. controlled power: 500 W

##### ■ 6.4 Climatic characteristics

Storage temperatures: - 10° C to + 70° C

Operating temperatures: - 5° C to + 50° C

#### 7. CLEANING

Surface cleaning with a cloth.

Do not use: acetone, tar remover, trichloroethylene.

#### 8. CONFORMITY - APPROVALS

Conform with standards of installation and manufacturing.

Refer to e.catalogue.